

MV-CL022-40GC

2048 P CMOS GigE Line Scan Camera

GEN*i*CAM

GigE
VISION



Introduction

MV-CL022-40GC camera supports line trigger mode, frame trigger mode, line + frame trigger mode, etc. It uses GigE interface to transmit non-compressed images in real time with max. line rate reaching 32 kHz.

Key Feature

- Adopts GigE interface and max. transmission distance of 100 meters without relay.
- Supports gain and exposure control, LUT, Gamma correction, etc.
- Compact design for flexible installation.
- Compatible with GigE Vision Protocol V2.0, GenICam Standard, and third-party software based on the protocol and standard.

Available Model

MV-CL022-40GC

Applicable Industry

Printing, metallurgy, food, pharmaceutical, transportation, logistics, material sorting, etc.

Sensor Quantum Efficiency

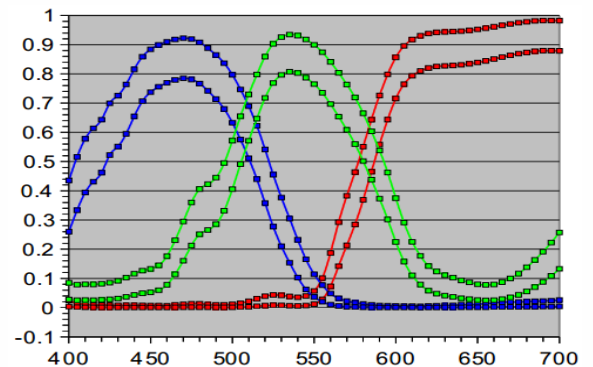

Dimension

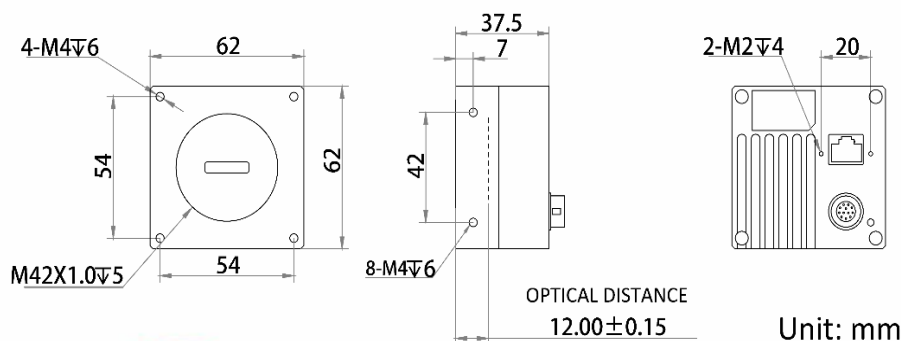

Specification

Model	MV-CL022-40GC
Camera	
Sensor type	CMOS
Pixel size	7 μm
Resolution	2048 \times 2
Max. line rate	32 kHz@ Bayer 8/Bayer 10p/Bayer 12p/ Mono 8 28 kHz@Bayer 10/Bayer 12/YUV 422 Packed/YUV 422 (YUYV) Packed/Mono 10/Mono 12 18 kHz@RGB 8/BGR 8
Dynamic range	60 dB
SNR	40 dB
Gain	0 dB to 7.9 dB
Exposure time	2 μs to 10 ms
Exposure mode	Off/Once/Continuous exposure mode, and supports trigger-width exposure
Mono/color	Color
Pixel format	Mono 8/10/12, Bayer RG 8/10/10p/12/12p, YUV 422 Packed, YUV 422 (YUYV) Packed, RGB 8, BGR 8
Binning	Not supported
Reverse image	Supports horizontal reverse image output
Trigger mode	External trigger, internal trigger
External trigger mode	Line trigger, frame trigger, line + frame trigger
Electrical feature	
Data interface	Gigabit Ethernet, compatible with Fast Ethernet
Digital I/O	12-pin Hirose connector provides power and I/O, including differential input \times 2 (Line 0, Line 3), differential output \times 2 (Line 1, Line 4), and bi-directional non-isolated I/O \times 1 (Line 2)
Power supply	12 VDC, supports PoE
Power consumption	Typ. 4 W@12 VDC
Mechanical	
Lens mount	M42*1, optical back focal length: 12 mm (0.5"), applicable to F-mount, C-mount and lens of other types via lens adapter
Dimension	62 mm \times 62 mm \times 37.5 mm (2.4" \times 2.4" \times 1.5")
Weight	Approx. 170 g (0.4 lb.)
Ingress protection	IP40 (under proper lens installation and wiring)
Temperature	Working temperature: 0 $^{\circ}\text{C}$ to 50 $^{\circ}\text{C}$ (32 $^{\circ}\text{F}$ to 122 $^{\circ}\text{F}$) Storage temperature: -30 $^{\circ}\text{C}$ to 70 $^{\circ}\text{C}$ (-22 $^{\circ}\text{F}$ to 158 $^{\circ}\text{F}$)
Humidity	20% to 80% RH, non-condensing
General	
Client software	MVS or third-party software meeting with GigE Vision Protocol
Operating system	32/64-bit Windows XP/7/10, 32/64-bit Linux and 64-bit MacOS
Compatibility	GigE Vision V2.0, GenICam
Certification	CE, RoHS, KC

HIKROBOT

Hangzhou Hikrobot Co., Ltd.
en.hikrobotics.com

© Hangzhou Hikrobot Co., Ltd. All Rights Reserved.
Hangzhou Hikrobot does not tolerate any infringement. Any organization or individual may not imitate or reproduce in whole or in part of the content. The data herein is based on Hikrobot's internal evaluation. Actual data may vary depending on specific configuration and operating condition. The information herein is subject to change without notice. All the content has been checked conscientiously. Nevertheless, Hikrobot shall not be liable to damages resulting from errors, inconsistencies or omissions.